

## 1948-56 Pickup Body Repair Parts

### Street Rod Firewall and Front Floorboards

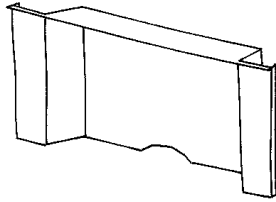

Fabricated steel

|           |                              |           |
|-----------|------------------------------|-----------|
| BN-481000 | 1948-52 Firewall: Smallblock | 450.00 ea |
| BN-481002 | 1948-52 Floorboard kit       | 350.00 ea |
| BN-531000 | 1953-56 Firewall: Smallblock | 525.00 ea |
| BN-531002 | 1953-56 Floorboard kit       | 350.00 ea |

### Transmission cover and floor

|               |                                        |           |
|---------------|----------------------------------------|-----------|
| 7C-700378     | 1948-52 Transmission cover, stock      | 125.00 ea |
| 7C-700378-T   | 1948-52 Transmission cover, extra tall | 165.00 ea |
| BAAA-700378-T | 1953-56 Transmission cover, extra tall | 165.00 ea |

### 1948-52 Pickup Patch Panels

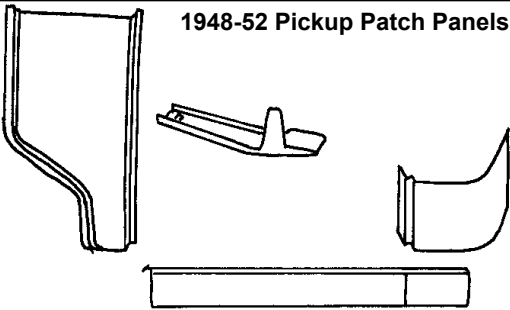

|               |                               |           |
|---------------|-------------------------------|-----------|
| 7C-114-R      | Cowl patch panel, RH          | 85.00 ea  |
| 7C-114-L      | Cowl patch panel, LH          | 85.00 ea  |
| 7C-114-I      | Cowl inner panel (body mount) | 55.00 pr  |
| 7C-114-H      | Cowl hinge post patch         | 55.00 pr  |
| 8C-8110110-PR | Cab sill panels               | 40.00 pr  |
| 7C-8140302-PR | Cab corner patch              | not.avbl  |
| 7C-8111105    | Floor panel in front of seat  | 200.00 ea |

### 1953-56 Pickup Patch Panels

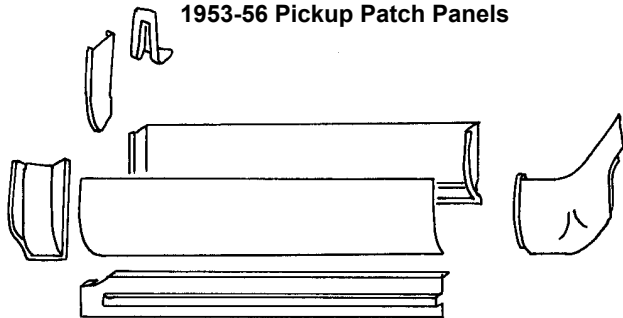

|                 |                                             |           |
|-----------------|---------------------------------------------|-----------|
| BAAA-8102054-PR | Cowl patch panels                           | 125.00 pr |
| BAAA-8102056-PR | Front body mounts                           | 60.00 pr  |
| BAAA-8102042-PR | Door pillar replacement (w/hinge pocket)    | 100.00 pr |
| BAAA-8120200-PR | Door outer patch panels                     | 110.00 pr |
| BAAA-8120124-PR | Door inner patch panels                     | 90.00 pr  |
| BAAA-8110110-PR | Rocker panels                               | 100.00 pr |
| BAAA-8140302-PR | Cab corner patches                          | 100.00 pr |
| BAAA-8110112-PR | Cab to running board seal retaining channel | 17.50 pr  |

### 1953-56 Floor

|             |                               |           |
|-------------|-------------------------------|-----------|
| BAAA-839-FL | Cab front floor LH, 1953-55   | 100.00 ea |
| BAAA-839-FR | Cab front floor RH, 1953-55   | 100.00 ea |
| B6C-839-FL  | Cab front floor LH, 1956      | 100.00 ea |
| B6C-839-FR  | Cab front floor RH, 1956      | 100.00 ea |
| B6C-839-BHC | Battery hole cover plate 1956 | 25.00 ea  |

## Special Hardware

### Rear Wheelwell Fender Studs

These are the large head studs that weld into the wheelwell for rear fender mounting on 1928-32 Passenger cars and 1932-47 Pickup boxes.

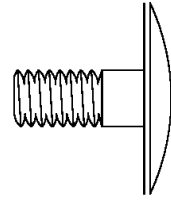

|         |          |          |
|---------|----------|----------|
| AH-1173 | Set of 4 | 2.50 set |
|---------|----------|----------|

### Cage Nuts

A nut in a sheetmetal cage to weld or braze into the body.

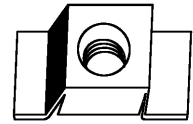

|           |       |         |
|-----------|-------|---------|
| AH-3145-B | 43834 | 1.50 ea |
| AH-3145   | 45428 | 1.50 ea |
| AH-3145-D | 45359 | 5.00 ea |
| AH-3145-E | 41276 | 2.50 ea |

### Capped nuts for exposed wood

Stainless Steel, used extensively on station wagons

|              |                                        |         |
|--------------|----------------------------------------|---------|
| AH-352353-SF | 5/16-24, .75 cap dia, .35 thread depth | 3.00 ea |
| AH-352353-LL | 5/16-18, .75 cap dia, .60 thread depth | 3.00 ea |
| AH-352353-SS | 5/16-18, .75 cap dia, .35 thread depth | 3.00 ea |
| AH-352353-SC | 3/8-24, .90 cap dia, .60 thread depth  | 3.00 ea |

### "D" Nuts

These are the special D shaped clinch nuts used extensively on Ford bodies. They are inserted into their hole and the flange is peened down to rivet them into the hole.



|           |       |         |
|-----------|-------|---------|
| AH-1123-A | 11963 | 0.50 ea |
| AH-1123   | 40901 | 0.50 ea |
| AH-1123-B | 43834 | 1.00 ea |
| AH-1123-D | 45428 | 2.50 ea |
| AH-1123-C | 45359 | 2.50 ea |
| AH-1123-E | 44028 | 2.50 ea |

### Body Nails

.074 dia x 3/4", .165 dia, Oval head, straight shank

|            |         |         |
|------------|---------|---------|
| AH-0003-C  | 100 qty | 1.50 ea |
| AH-0003-5C | 500 qty | 7.50 ea |

.085 dia x 7/8", .165 dia, flat head, twist shank

|            |         |          |
|------------|---------|----------|
| AH-0004-C  | 100 qty | 2.00 ea  |
| AH-0004-5C | 500 qty | 12.50 ea |

### Body Insulation

|           |                                       |          |
|-----------|---------------------------------------|----------|
| HR-700770 | Heavy duty foil backed jute 36" x 48" | 30.00 ea |
|-----------|---------------------------------------|----------|

\* Parts with price listed as "not.avbl" are not known to be available at this time, but are listed for reference.