

1935-36 Coupe, Roadster, Sedan, and Phaeton Body Repair Parts

1935-36 Passenger Front Floor (original type)

48-700325-S	1935 Front floorboards, wood	120.00	pr
68-700325-S	1936 Front floorboards, wood		not.avbl
68-700364/5	Front floorboard to body seal, rubber	105.00	pr
AH-3141	1933-40 Floorboard mount screws, 28 pcs	5.00	set
AH-3143	1935-36 Trans cover mount screws, 22 pcs	2.50	set
48-700394	Pedal, dimmer, steering to floor seal, rubber	10.00	set
40-700382	1935 Transmission top to floor rubber pad set	10.00	ea
68-700382	1936 Transmission top to floor rubber pad	10.00	ea
48-700386	Bumpers for brake & clutch pedals	7.50	pr
48-35122	Pedal & column seal cover plate set	22.50	ea

Street Rod Firewall and Front Floorboards

Firewall: Smallblock

BN-351071 475.00 ea

Firewall: Bigblock

BN-351010 475.00 ea

Front floor/transmission hump

(use with original firewall)

BN-351077 350.00 ea

use with smallblock firewall

BN-351073 350.00 ea

use with bigblock firewall

BN-351014 350.00 ea

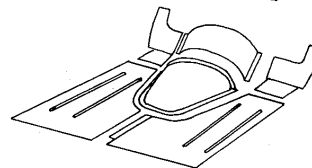
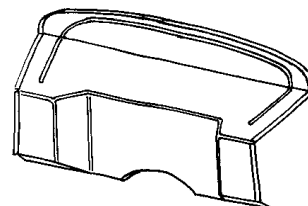

1935-36 Passenger Body Patch Panels, Steel

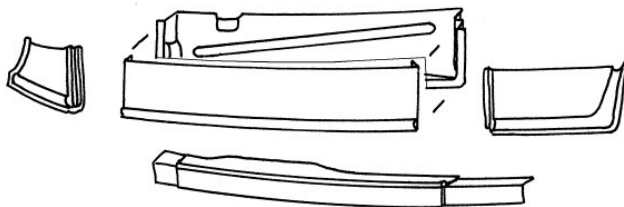

Cowl patch panels

48-114 Passenger models 90.00 pr

Door outer patch panels (formed steel)

48-236 3-Window coupe & Tudor sedan 72.50 pr

48-336 5-Window coupe & Roadster not.avbl

Door outer and inner patch kit (die stamped)

includes inner and outer for one door

48-236-IOR RH, 3 Window coupe, tudor sedan, cabriolet 225.00 ea

48-236-IOL LH, 3 Window coupe, tudor sedan, cabriolet 225.00 ea

48-336-IOR RH, 5 Window coupe, roadster, fordor ft door 225.00 ea

48-336-IOL LH, 5 Window coupe, roadster, fordor ft door 225.00 ea

Quarter patch panels

48-150 5-Window coupe & Roadster 90.00 pr

48-250 3-Window coupe & Tudor 90.00 pr

Rocker panel replacements

48-239 Tudor & 3-Window (modify for 5 Window) 210.00 pr

Street Rod Wheelwells

Steel, have extra room for tire

48-181-W Coupes, Sedans, Convertibles 450.00 pr

* Parts with price listed as "not.avbl" are not known to be available at this time, but are listed for reference.

1935-36 Coupe, Roadster, Sedan, and Phaeton Body Repair Parts, cont

Wescott's Deck Lids, Fiberglass

Wescott's deck lids are constructed with fiberglass inner and outer panels glued together. We install internal steel support structures between the inner and outer panels which reinforce rumble and trunk hinge mounts, seat spring and trunk prop mounts.



DL3536CR Roadster, Coupe and Cabriolet 850.00 ea

Panel Below Deck Lid

Stamped Steel, good quality. Requires minor reshaping and fitting during installation.

Coupe, Roadster, Cabriolet:

48-725250 325.00 ea

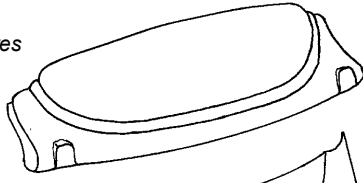

Slantback Sedans

48-704058-A 325.00 ea

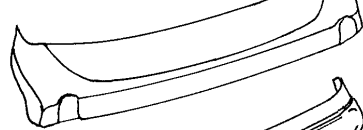

Humpback Sedans

48-704058-B 325.00 ea



Inner Panel below Deck

All Passenger

48-725250-T 325.00 ea

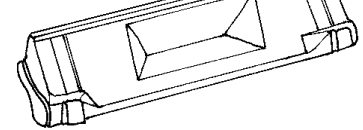

Trunk Floor Parts

Trunk Riser:

48-257 125.00 ea

Section behind riser

48-255 110.00 ea

Rear extension (sedans only)

48-255-S 115.00 ea

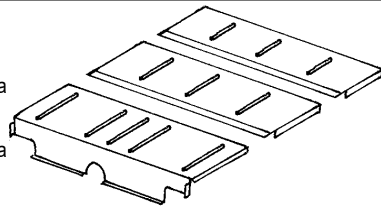

Street Rod

Steel Floor Kits

Manufactured in multiple sections to allow UPS shipping.

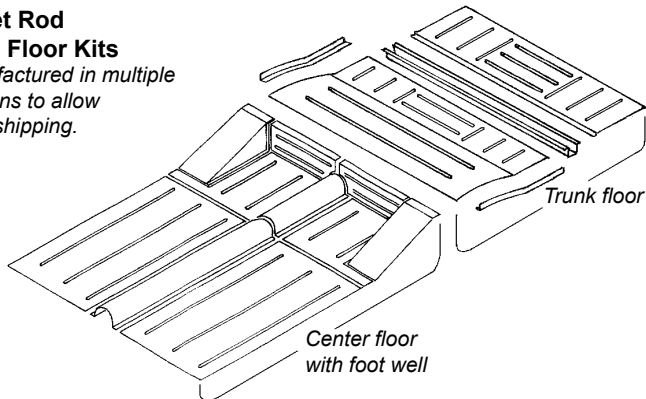

BN-351049 Center floor, 59" from body mt*, Sedans 325.00 ea

BN-351050 Center floor, 68 1/2" from body mt*, Coupes 325.00 ea

BN-351085 Trunk floor, Sedans 375.00 kit

BN-351090 Trunk floor, Coupe, Roadster, Cabriolet 375.00 kit

*Measure from body bolt at hinge post to front of rear seat platform.

Under Floor Stiffner Wood

VWD-35C-FLOOR 1935-36 Coupes, Sedans, Roadster, Phaeton not.avbl

Roadster and Phaeton Body Wood Parts

VWD-35R-DRPOST Door post wood 3536R not.avbl

VWD-35R-DOOR Door frame wood 3536RPH not.avbl

VWD-35R-COWL Cowl frame wood 3536RPH not.avbl

Coupe and Sedan Body Wood Parts

VWD-35S2-TOPRIB Top rib wood 3536 Tudor not.avbl

VWD-35W3-TOPRIB Top rib wood 3536 3 Window 190.00 set

VWD-35W3-PACK Package tray wood 3536 3W not.avbl

VWD-35S4-TOPRIB Top rib wood 3536 Fordor not.avbl

VWD-35W5-PACK Package tray wood 3536 5W not.avbl

VWD-35W5-TOPRIB Top rib wood 3536 5 Window 190.00 set

VWD-35C-DRPOST Door post filler wood 3536 Cpe not.avbl

VWD-35C-WSHFIL Wsh side filler wood 3536C/S not.avbl

Cabriolet & Convertible Sedan Body Wood Parts

VWD-35CB-WSHFIL Wsh side filler wood 3536Cabr not.avbl

VWD-35CB-PACK Package tray wood 3536 Cabr not.avbl

VWD-35CB-DRPOST Door post filler wood 3536Cabr not.avbl

VWD-35CVS-BELT Rear belt rail 3536CnvSdn 1125.00 ea

VWD-35CVS-RPST Rear post tack blocks 3536CnvS 55.00 pr

VWD-35CVS-RPST Rear door post wood 3536CnvS 55.00 pr

VWD-35CVS-CPST Center post wood 3536CnvS 130.00 pr

VWD-35CVS-WCHA Wdo channel tack wood 3536CnvS not.avbl

Sedan Delivery Body Wood Parts

VWD-35SD-FPOST Front door post wood 3539SD 550.00 pr

VWD-35SD-SPOSTM Side post middle wood 3539SD 90.00 pr

VWD-35SD-SPOSTR Side post rear wood 3539SD 225.00 pr

VWD-35SD-SCROSL Side cross lower wood 3539SD 75.00 pr

VWD-35SD-SCROSM Side cross middle wood 3539SD 105.00 pr

VWD-35SD-HEADU Side door header wood 3539SD 300.00 pr

VWD-35SD-RFRAME R door jamb frame wood 3539SD 1575.00 set

VWD-35SD-RDOOR Rear door wood 3539SD 1450.00 ea

VWD-35SD-TOPRIB Top ribs, wood 3539SD not.avbl

* Parts with price listed as "not.avbl" are not known to be available at this time, but are listed for reference.

Special Hardware

Rear Wheelwell Fender Studs

These are the large head studs that weld into the wheelwell for rear fender mounting on 1928-32 Passenger cars and 1932-47 Pickup boxes.

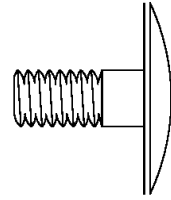

AH-1173	Set of 4	2.50	set
---------	----------	------	-----

Cage Nuts

A nut in a sheetmetal cage to weld or braze into the body.

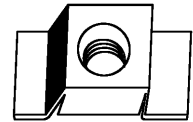

AH-3145-B	43834	1.50	ea
AH-3145	45428	1.50	ea
AH-3145-D	45359	5.00	ea
AH-3145-E	41276	2.50	ea

Capped nuts for exposed wood

Stainless Steel, used extensively on station wagons

AH-352353-SF	5/16-24, .75 cap dia, .35 thread depth	3.00	ea
AH-352353-LL	5/16-18, .75 cap dia, .60 thread depth	3.00	ea
AH-352353-SS	5/16-18, .75 cap dia, .35 thread depth	3.00	ea
AH-352353-SC	3/8-24, .90 cap dia, .60 thread depth	3.00	ea

"D" Nuts

These are the special D shaped clinch nuts used extensively on Ford bodies. They are inserted into their hole and the flange is peened down to rivet them into the hole.



AH-1123-A	11963	0.50	ea
AH-1123	40901	0.50	ea
AH-1123-B	43834	1.00	ea
AH-1123-D	45428	2.50	ea
AH-1123-C	45359	2.50	ea
AH-1123-E	44028	2.50	ea

Body Nails

.074 dia x 3/4", .165 dia, Oval head, straight shank

AH-0003-C	100 qty	1.50	ea
AH-0003-5C	500 qty	7.50	ea

.085 dia x 7/8", .165 dia, flat head, twist shank

AH-0004-C	100 qty	2.00	ea
AH-0004-5C	500 qty	12.50	ea

Body Insulation

HR-700770	Heavy duty foil backed jute 36" x 48"	30.00	ea
-----------	---------------------------------------	-------	----

* Parts with price listed as "not.avbl" are not known to be available at this time, but are listed for reference.