

## 1932-34 Pickup Body Repair Parts

### 1932 Firewall, inserts into body as original

Original design where the body clamps over the firewall. Uses original style rubber seal. Front lip on firewall accepts stock hood lacing.

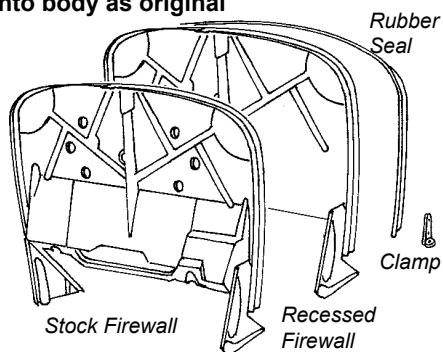

B-35000-R	Recessed, w/lacing lip, steel	475.00 ea
B-35000-S	Stock style, w/ lacing lip, steel	950.00 ea
B-114-M	Cowl side/firewall clamp brackets	150.00 ea
B-35336	Cowl to firewall rubber seal	15.00 ea

### Street Rod Steel Floorboards for Stock Firewall

BN-321033	1932 Steel front floorboard & trans hump	300.00 ea
-----------	--	-----------

### 1932 Front Floorboards, (Original type)

AH-3140	1932 Floorboard mount screws, 30 pcs	5.00 set
A-35130-S	Front floorboard to body seal, felt	15.00 ea
B-35190	Pedal & steering tube to floor seal, rubber	10.00 ea
B-35195	Transmission top to floor rubber pads	10.00 ea
B-35184	Bumpers for brake & clutch pedals	7.50 pr
B-35122	Pedal & column seal cover plates	22.50 ea

### Street Rod Steel Firewall and Floorboards

1932 Welds into body on hood drain channel and not have original style hood lacing lip so stock hood lacing cannot be used.

1933-34 can use stock lacing.

Setback is measured from cowl edge of body.

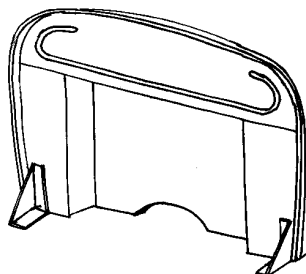

BN-321040	1932 Smallblock firewall (1 3/4" setback)	425.00 ea
BN-321042	1932 Bigblock firewall (4" setback)	425.00 ea
BN-321065	1932 Front floorboard & trans hump (sm-bk)	350.00 ea
BN-321068	1932 Front floorboard & trans hump (big-bk)	350.00 ea

BN-331000	1933-34 Smallblock firewall	450.00 ea
BN-331002	1933-34 Floorboard & trans hump (sm-blk)	350.00 ea
BN-331002-S	1933-34 Floorboard & trans hump (stk fw)	350.00 ea

### 1932-34 Pickup Cab Floor Panels, Steel

B-835	Panel under seat	80.00 ea
BN-321077-PU	Panel under seat, smooth style	100.00 ea
B-831	Cab rear crossmember	225.00 ea

### 1932-34 Pickup Cab Patch Panels, Steel

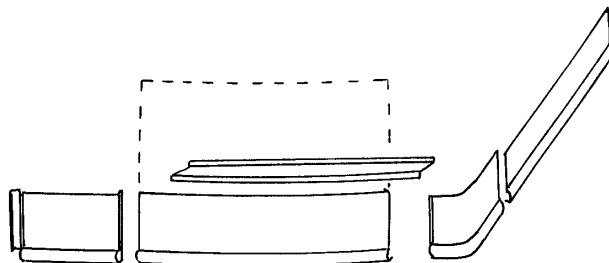

B-814	Cowl patch panels	70.00 pr
B-836	Door outer patch panels 6"	100.00 pr
B-836-TR	Door outer patch, RH, 22" tall	105.00 ea
B-836-TL	Door outer patch, LH, 22" tall	105.00 ea
B-836-I	Door inner patch, 1932-34 Pickup	50.00 pr
B-47301-PU	Roof drip rails, formed to fit	185.00 pr
B-870	Cab corner patch panels	85.00 pr
B-850	Cab back patch, 4' long w/straight bead	100.00 ea

### Pickup Body Wood

VWD-32PU-SBU	Belt rail/window side wood, 32-33	155.00 ea
VWD-34PU-SBU	Belt rail/window side wood, 34	140.00 ea
VWD-32PU-SBL	Seat back lower mount wood, 32-33	135.00 ea

### Pickup Cab Back To Cab Wood Special Bolts

B-82599-CB	1932-34 Pickup cab	1.50 ea
------------	--------------------	---------

### Roadster Pickup Body Wood

Note: This is for the real roadster pickup (looks like a cut down pickup), not the street rod version with roadster cowl and doors.

VWD-32RPU-DOORL	Door frame wood LH 3234RPU	775.00 ea
VWD-32RPU-DOORR	Door frame wood RH 3234RPU	775.00 ea

\* Parts with price listed as "not.avbl" are not known to be available at this time, but are listed for reference.

### Special Hardware

#### Rear Wheelwell Fender Studs

*These are the large head studs that weld into the wheelwell for rear fender mounting on 1928-32 Passenger cars and 1932-47 Pickup boxes.*

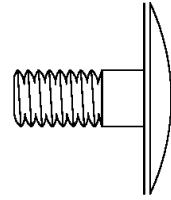

AH-1173	Set of 4	2.50	set
---------	----------	------	-----

#### Cage Nuts

*A nut in a sheetmetal cage to weld or braze into the body.*

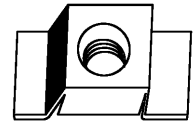

AH-3145-B	43834	1.50	ea
AH-3145	45428	1.50	ea
AH-3145-D	45359	5.00	ea
AH-3145-E	41276	2.50	ea

#### Capped nuts for exposed wood

*Stainless Steel, used extensively on station wagons*

AH-352353-SF	5/16-24, .75 cap dia, .35 thread depth	3.00	ea
AH-352353-LL	5/16-18, .75 cap dia, .60 thread depth	3.00	ea
AH-352353-SS	5/16-18, .75 cap dia, .35 thread depth	3.00	ea
AH-352353-SC	3/8-24, .90 cap dia, .60 thread depth	3.00	ea

#### "D" Nuts

*These are the special D shaped clinch nuts used extensively on Ford bodies. They are inserted into their hole and the flange is peened down to rivet them into the hole.*



AH-1123-A	11963	0.50	ea
AH-1123	40901	0.50	ea
AH-1123-B	43834	1.00	ea
AH-1123-D	45428	2.50	ea
AH-1123-C	45359	2.50	ea
AH-1123-E	44028	2.50	ea

#### Body Nails

*.074 dia x 3/4", .165 dia, Oval head, straight shank*

AH-0003-C	100 qty	1.50	ea
AH-0003-5C	500 qty	7.50	ea

*.085 dia x 7/8", .165 dia, flat head, twist shank*

AH-0004-C	100 qty	2.00	ea
AH-0004-5C	500 qty	12.50	ea

#### Body Insulation

HR-700770	Heavy duty foil backed jute 36" x 48"	30.00	ea
-----------	---------------------------------------	-------	----

\* Parts with price listed as "not.avbl" are not known to be available at this time, but are listed for reference.